

PROMINENT STREET FRONT SPACE AVAILABLE

SWC DIVISION & LASALLE

Old Town | Chicago



PROMINENT STREET FRONT SPACE AVAILABLE
SWC DIVISION & LASALLE
 Old Town | Chicago, IL



SPACE AVAILABLE

- ±505 SF & ±909 SF - *Can be combined*
- ±617SF & ±1,010 SF - *Can be combined*

SITE SUMMARY

- Situated in Chicago’s Old Town neighborhood, at the prime southwest corner of Division Street and LaSalle Street.
- The location boasts exceptionally high household incomes—averaging over \$184,000 within a half-mile radius—and a dense residential population of 45,676 people in the same area.
- Conveniently positioned directly across from the Clark & Division CTA “L” station, offering strong transit accessibility.

AREA TENANTS



DEMOGRAPHICS

sweetgreen	1/2 Mile	1 Mile	2 Miles
Total Population	45,676	97,784	243,690
Average HH Income	\$184,496	\$197,850	\$205,222
Daytime Population	39,788	150,232	709,734

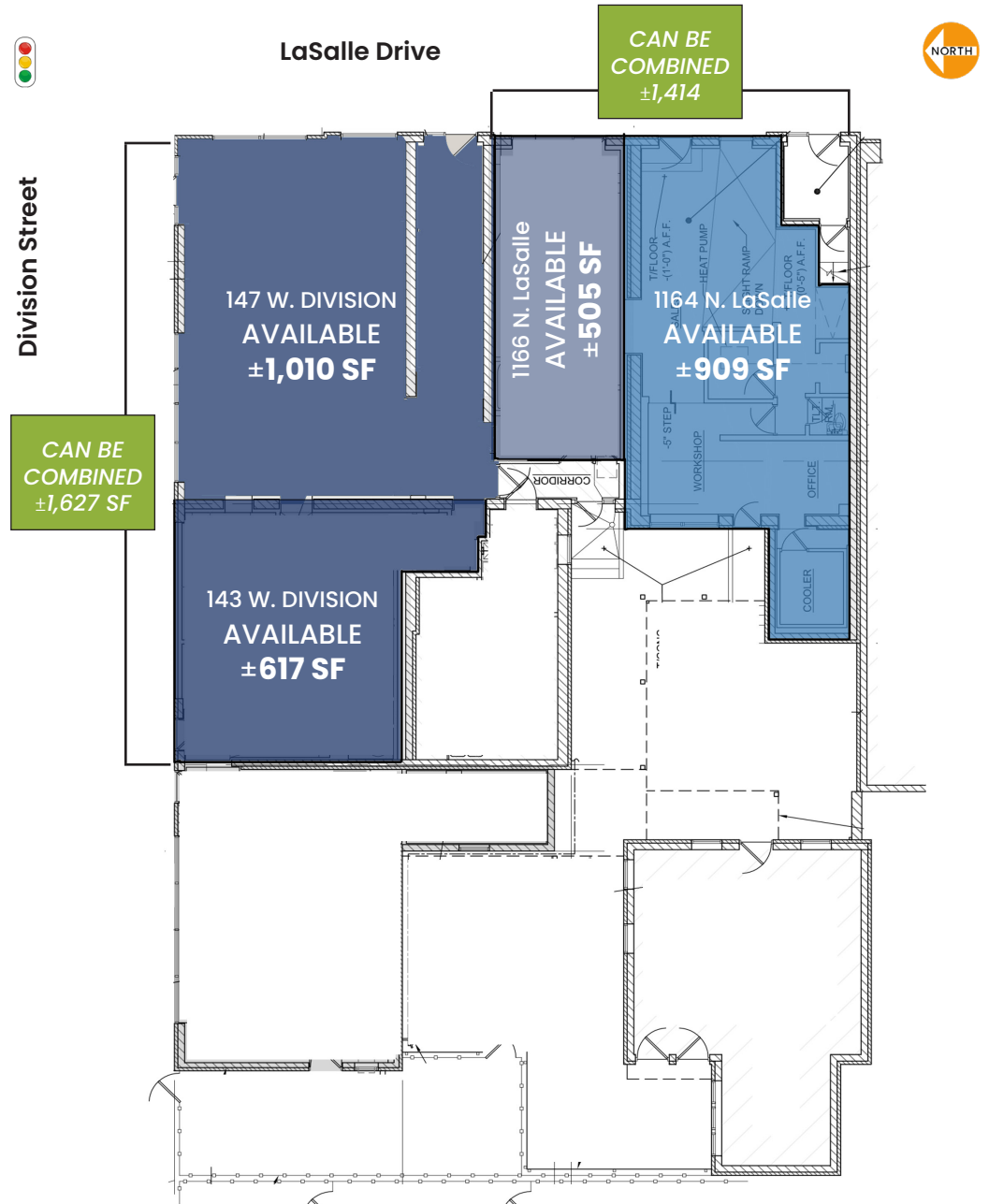

PROMINENT STREET FRONT SPACE AVAILABLE
SWC DIVISION & LASALLE
 Old Town | Chicago, IL



MATT CAVANAGH
 matt@arcgrp.com
 630.908.5694

LAUREN SZYMELL
 lszymell@arcgrp.com
 630.908.5703

© 2022 ARC Real Estate. All information is from sources believed reliable, not independently verified, and thus subject to errors, omissions, and modifications such as price, listing, square footage, rates and commissions. All information, estimates and projections subject to change, market assumptions, unknown facts and conditions, and future potentialities. ARC Real Estate makes no express or implied representations or warranties, as facts and results may vary materially from all information, estimates and projections. All renderings presented are conceptual.