

1,998 SF AVAILABLE FOR LEASE

1938 W. NORTH AVENUE

Northeast Quadrant of North and Damen | Wicker Park, Chicago



1,998 SF AVAILABLE FOR LEASE

1938 W. NORTH AVENUE

Northeast Quadrant of North and Damen | Wicker Park, Chicago



SPACE AVAILABLE

1,998 SF

SITE SUMMARY

- Dense, high foot traffic neighborhood location with young, affluent customer base
- Join Wicker Park / Bucktown's "world class" retail and restaurant scene
- Steps from the CTA Blue Line Damen 'L' station and boutique hotel, The Robey
- Available for Immediate Occupancy

NEIGHBORING TENANTS

Foxtrot, Etta, Paradise Park, Piece Brewery, Champion, Urban Outfitters, Carhartt, YETI and more

DEMOGRAPHICS

	1/2 Mile	1 Miles	2 Miles
Total Population	19,530	66,006	235,204
Average HH Income	\$186,037	\$160,388	\$158,260
Daytime Population	13,146	31,700	112,235

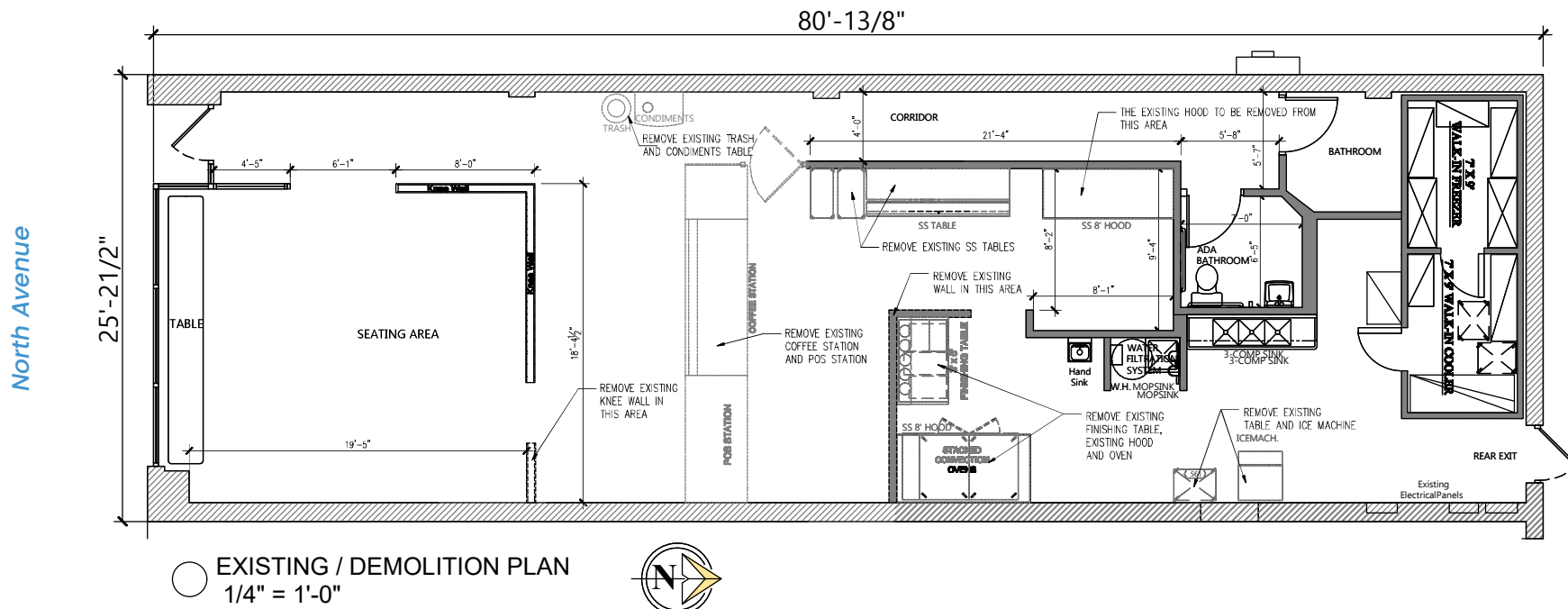

1,998 SF AVAILABLE FOR LEASE

1938 W. NORTH AVENUE

Northeast Quadrant of North and Damen | Wicker Park, Chicago



SITE

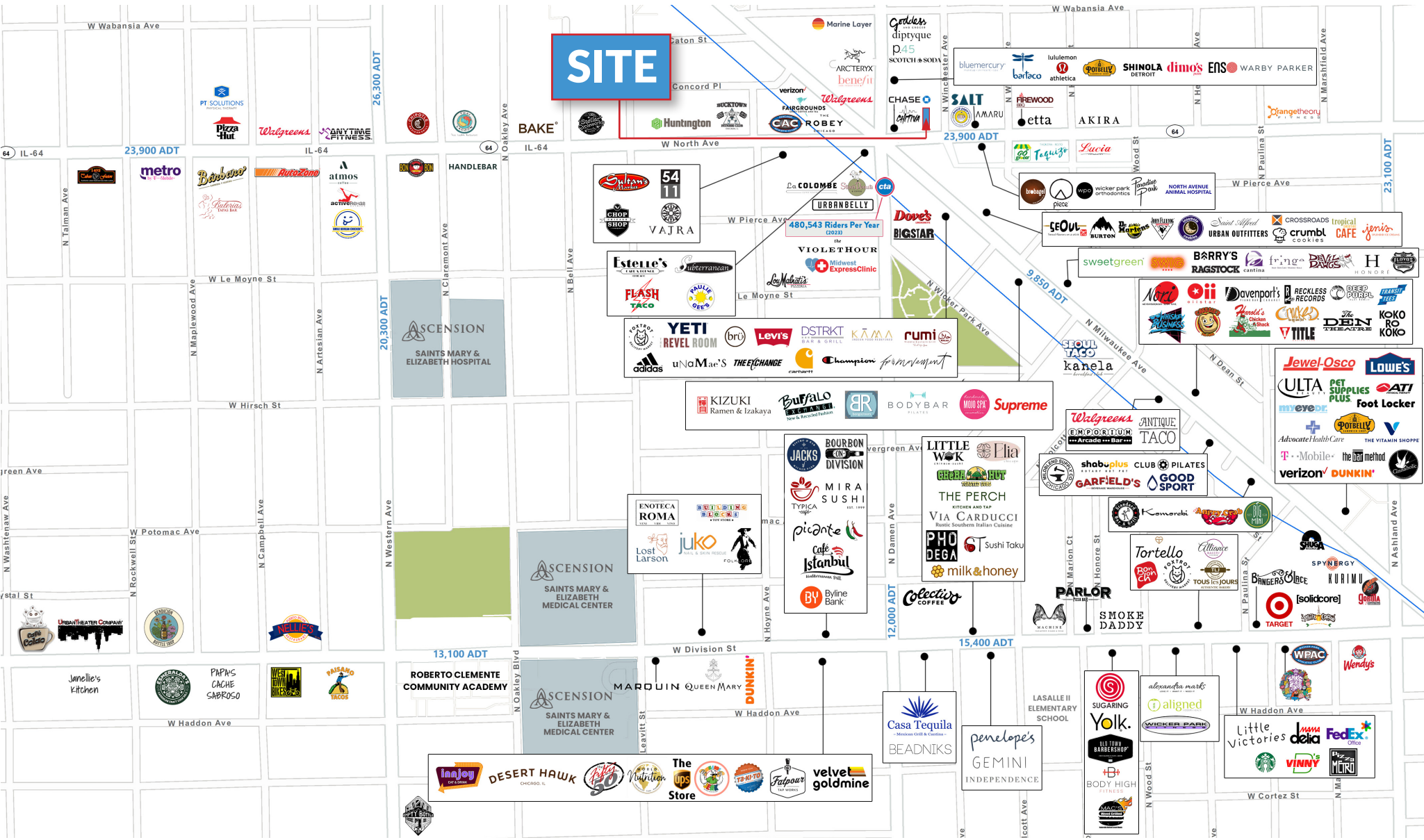

MATT CAVANAGH
 matt@arcgrp.com
 630.908.5694

LAUREN SZYMELL
 lszymell@arcgrp.com
 630.908.5703