

RETAIL/OFFICE SPACE AVAILABLE FOR LEASE

# LINCOLNSHIRE VILLAGE GREEN

NEC Old Half Day Road and Milwaukee Avenue | Lincolnshire, IL



# LINCOLNSHIRE VILLAGE GREEN

NEC Old Half Day Road and Milwaukee Avenue | Lincolnshire, IL



## RETAIL SPACE AVAILABLE

844 SF, 1,266 SF & 3,337 SF

## SITE SUMMARY

- Ample Parking
- Easy Access to I-94 via Half Day Road
- Set in Affluent Trade Area with High Daytime Population

## AREA TENANTS



## DEMOGRAPHICS

	1 Mile	3 Miles	5 Miles
<b>Total Population</b>	5,032	51,011	161,597
<b>Average HH Income</b>	\$236,706	\$230,225	\$199,653
<b>Daytime Population</b>	14,535	76,910	210,113

SUITE	SF	TENANT	SUITE	SF	TENANT
<b>BUILDING 100</b>			<b>BUILDING 300</b>		
100	5,940	Bright Stars Kids University	100	4,000	Plenty of Huevos
120	6,906	Advocate Medical Group	105	898	Fresh Green Light
<b>BUILDING 185</b>			<b>110</b>	<b>3,337</b>	<b>AVAILABLE</b>
100	10,169	Eddie Merlot's	<b>110A</b>	<b>844</b>	<b>AVAILABLE</b>
110	1,500	Expert Family Eyecare	116	1,180	Jeweler
120	4,725	Salon Bennett	112-125	3,160	Move Studio
130	2,26	Einstein Bros. Bagels	<b>135</b>	<b>1,266</b>	<b>AVAILABLE</b>
135	1,719	Metro Infusion Center	140	1,050	Cleaners
140	1,725	Children's Oral Care Only	145	1,240	Sally's Nail Spa
150	4,815	Starfish Sushi	150	2,100	Village Green Dentistry
<b>BUILDING 200</b>					
200	14,500	Half Day Brewing Company			

# LINCOLNSHIRE VILLAGE GREEN

NEC Old Half Day Road and Milwaukee Avenue | Lincolnshire, IL

## OFFICE SPACE AVAILABLE

### 100 VILLAGE GREEN DRIVE

Suite 210B	1,321 SF
Suite 205	1,331 SF

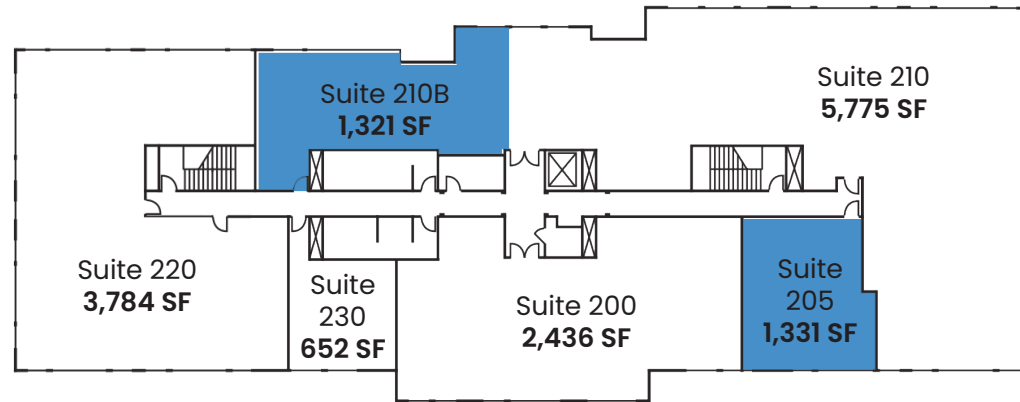

## OFFICE SUITES

## OFFICE SPACE AVAILABLE

### 185 MILWAUKEE AVENUE

Suite 200	1,778 SF
SUITE 202-204	4,338 SF
SUITE 220	1,788 SF

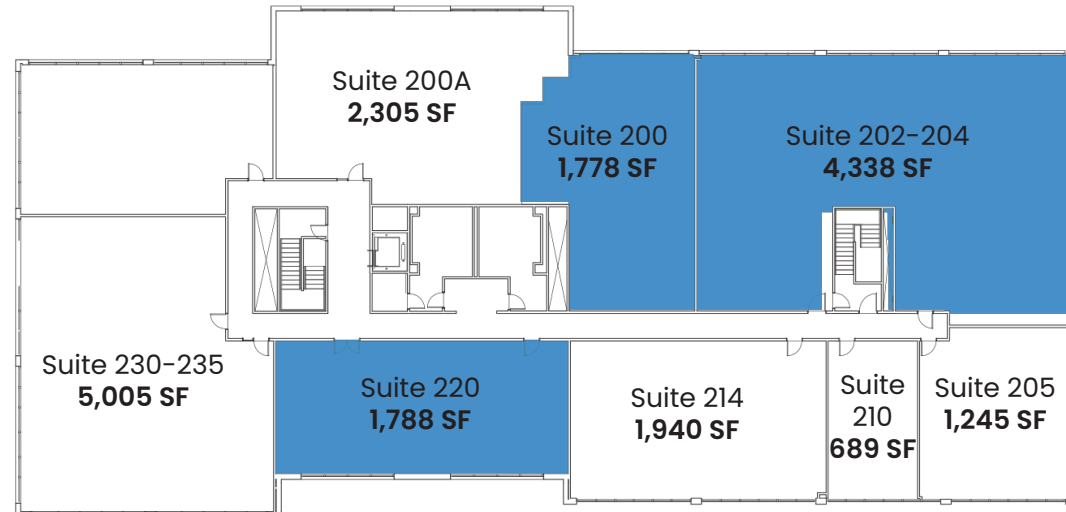

## OFFICE SPACE AVAILABLE

### 300 VILLAGE GREEN DRIVE

Suite 200	3,420 SF
Suite 210	2,582 SF

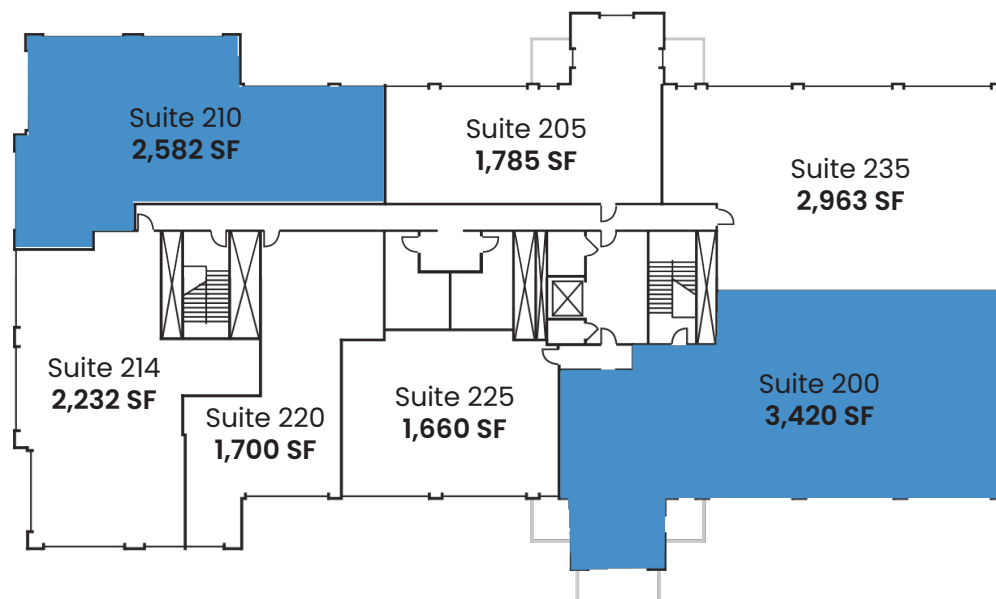

RETAIL/OFFICE SPACE AVAILABLE FOR LEASE

# LINCOLNSHIRE VILLAGE GREEN

NEC Old Half Day Road and Milwaukee Avenue | Lincolnshire, IL

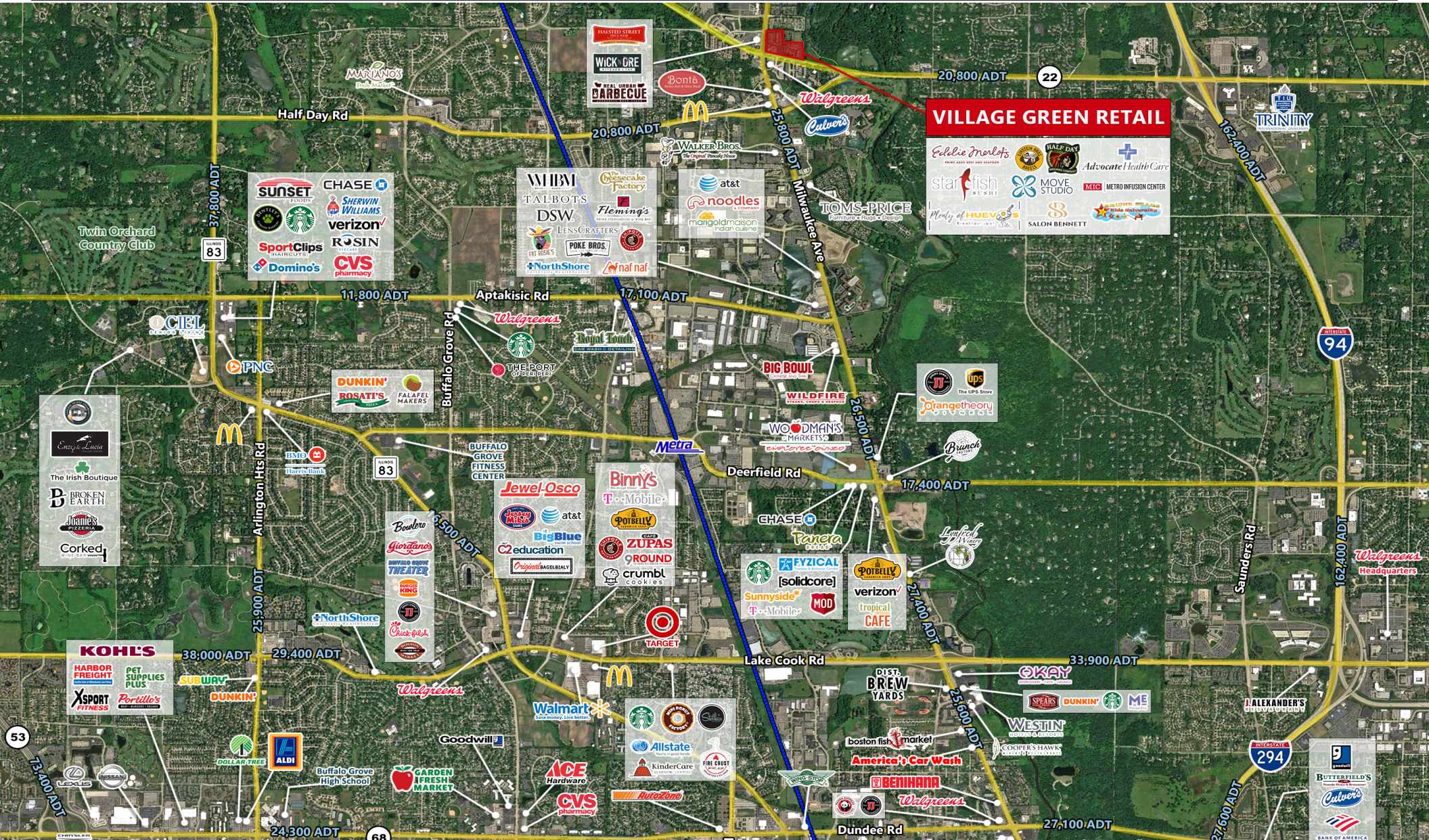

**CONTACT**  
**MATT CAVANAGH**  
 matt@arcgrp.com  
 630.908.5694

**LAUREN SZYMELL**  
 lszymell@arcgrp.com  
 630.908.5703

**JEANNE ELLIOTT**  
 jeanne@arcgrp.com  
 630.908.5696