

BUILD TO SUIT | GROUND LEASE

# ROUTE 83 & MONAVILLE RD

36650 N. Bernice | Lake Villa, IL





# ROUTE 83 & MONAVILLE RD

36650 N. Bernice | Lake Villa, IL

LAND AVAILABLE | BUILD TO SUIT OR GROUND LEASE

48,000 SF (1.1 Acres)

**Prime Location** The 1.1-acre lot is located at a high-visibility stoplight corner across from Walmart, ensuring maximum exposure and traffic.

**Development Potential** The site offers flexibility for build-to-suit or ground lease options, making it suitable for various commercial or mixed-use projects.

**Growing Area** The property is situated in a rapidly growing neighborhood, just 0.3 miles from a new 250-unit apartment complex, ensuring a steady customer base.

**Accessibility** The site has convenient access to major roads and public transit, enhancing its attractiveness for potential businesses.

DEMOGRAPHICS

	1 MILE	3 MILES	5 MILES
Total Population	9,366	63,244	138,301
Average HH Income	\$148,606	\$143,452	\$152,391
Daytime Population	5,824	44,019	100,226

OPTION 1

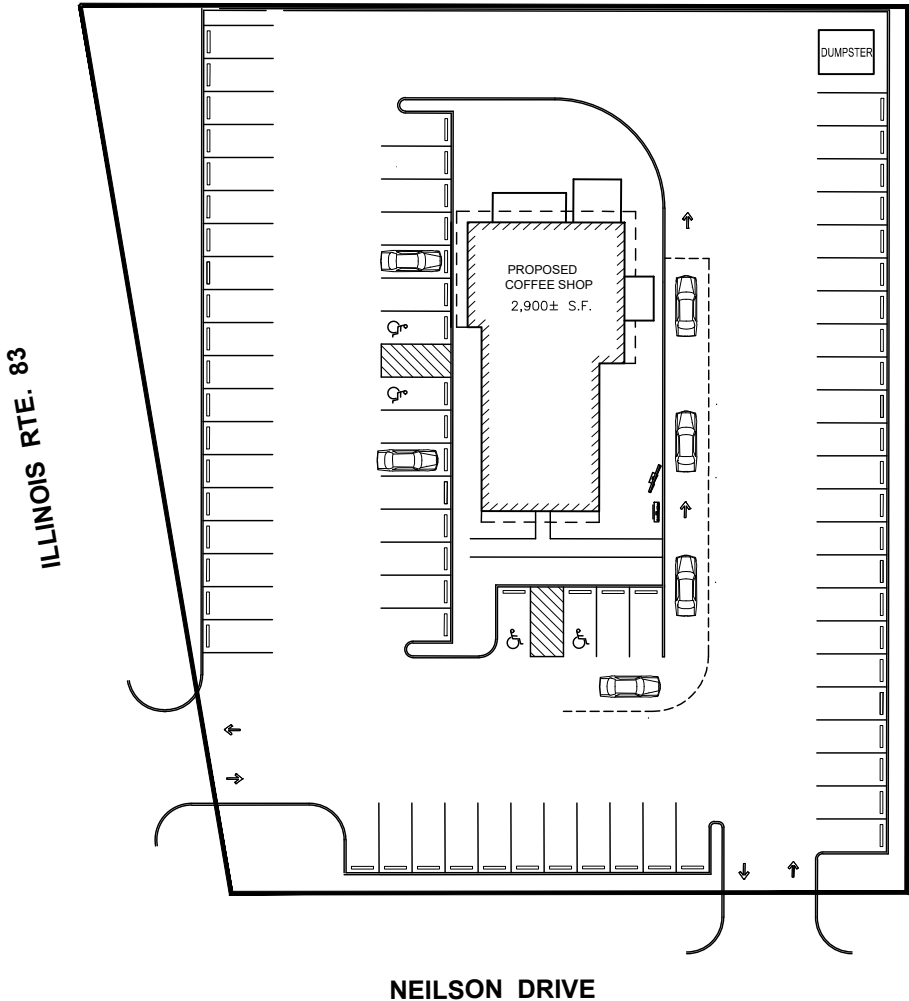

ROUTE 83 & MONAVILLE RD

36650 N. Bernice | Lake Villa, IL

OPTION 2

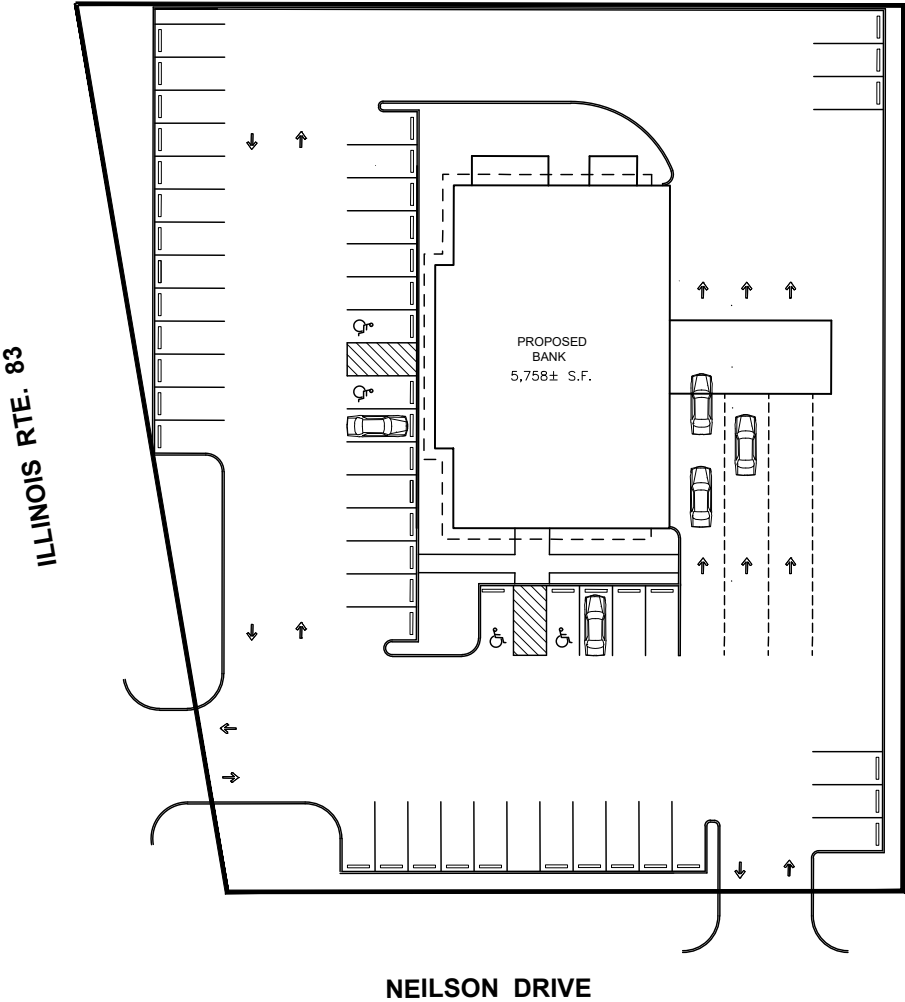

OPTION 3

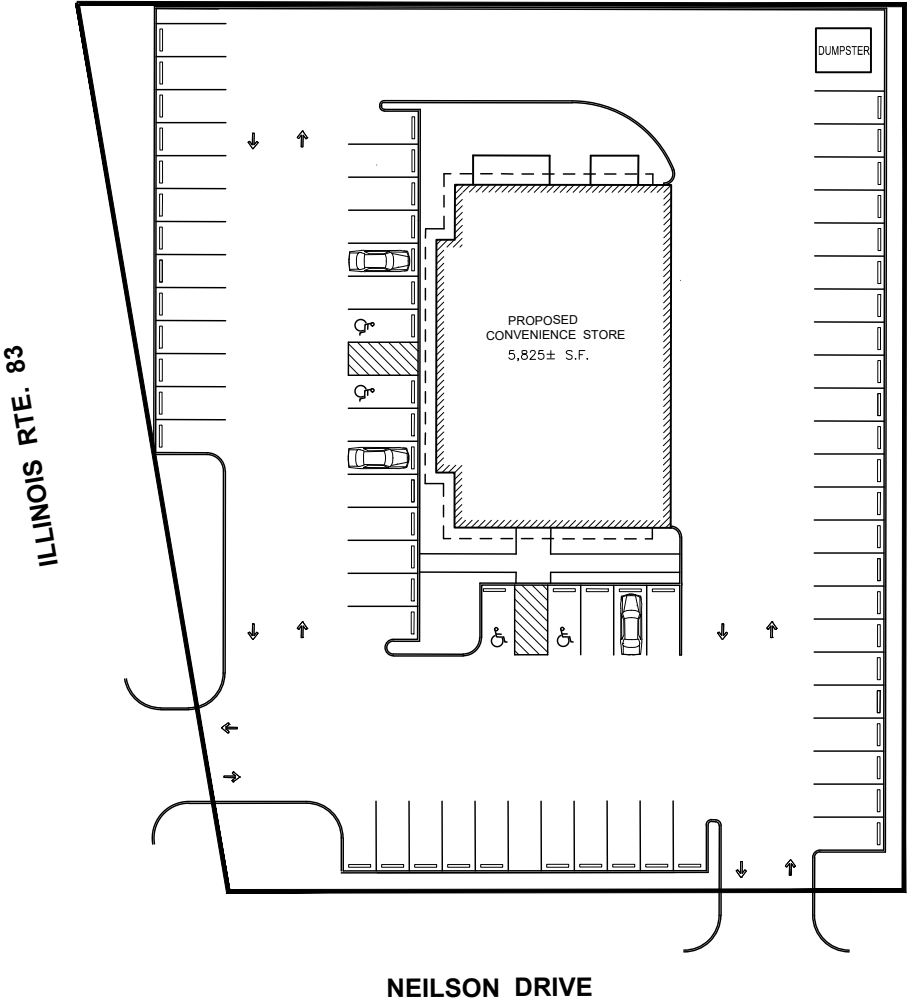



BUILD TO SUIT | GROUND LEASE

# ROUTE 83 & MONAVILLE RD

36650 N. Bernice | Lake Villa, IL

**A·R·C**  
REAL ESTATE



**MATT CAVANAGH**  
matt@arcgrp.com  
630.908.5694

**LAUREN SZYMELL**  
lszymell@arcgrp.com  
630.908.5703

**DANIELLE KLING**  
danielle@arcgrp.com  
630.908.5693

© 2024 ARC Real Estate. All information is from sources believed reliable, not independently verified, and thus subject to errors, omissions, and modifications such as price, listing, square footage, rates and commissions. All information, estimates and projections subject to change, market assumptions, unknown facts and conditions, and future potentialities. ARC Real Estate makes no express or implied representations or warranties, as facts and results may vary materially from all information, estimates and projections. All renderings presented are conceptual.

**REALTY RESOURCES**  
MEMBER