

JOIN FUTURE WOODMAN'S MARKETS

PREMIER RETAIL DEVELOPMENT OPPORTUNITY

NEC Route 59 and 119th Street | Plainfield, Illinois

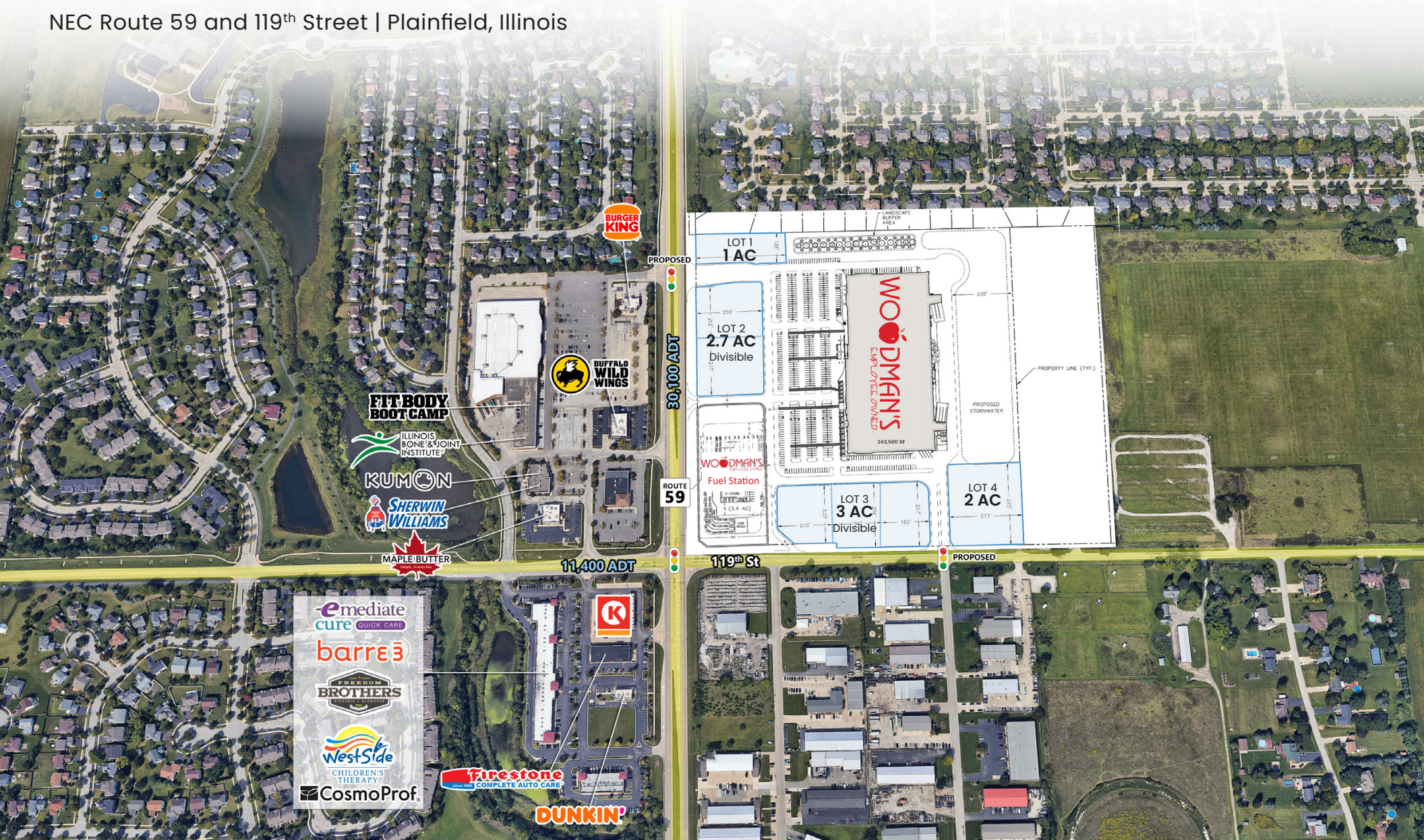

OUTLOTS AVAILABLE

NEC Route 59 and 119th Street | Plainfield, Illinois

KEY HIGHLIGHTS

High-Traffic Location Strategically positioned at Route 59 & 119th Street, ensuring maximum visibility and accessibility

Anchored by Woodman's Markets

- » 243,500 SF grocery store
- » Store opening projected for Q3 2026

Outlots Available

- » Spring/Summer 2026 Delivery
- » Flexible Outlot Sizes
- » Prime Real Estate for retail, restaurant, and medical uses

Highly Visible & Accessible

- » Situated in a growing commercial corridor
- » 119th Street is a Strategic Regional Arterial designed for traffic to connect from Route 59 east to Weber Road

DEMOGRAPHICS

	1 Mile	3 Miles	5 Miles
Total Population	7,694	58,826	170,308
Average HH Income	\$204,079	\$229,271	\$192,386
Daytime Population	7,644	48,557	135,031

