

RETAIL AND OUTLOTS AVAILABLE FOR LEASE OR GROUND LEASE

6550 N. ALPINE ROAD

SEC Alpine Road and Forest Hills Road | Loves Park, Illinois 61111



6550 N. ALPINE ROAD

SEC Alpine Road and Forest Hills Road | Loves Park, Illinois 61111

RETAIL AVAILABLE

6550 N Alpine Road – ±72,370 SF former grocer space with open floor plan and high ceilings

OUTLOTS AVAILABLE

6915 Forest Hills Road – ±0.80 Acres

- Corner site with QSR, coffee, or retail service potential

6552 N Alpine Road – ±0.53 Acres (Can be expanded)

- Prominent pad site, ideal for drive-thru or small retail

PROPERTY HIGHLIGHTS

- Located in the heart of Loves Park's primary retail hub
- Ample parking and convenient access from multiple points
- Surrounded by top national and regional retailers including Walmart, Menards, and Meijer
- Strong demographics with dense residential population and robust daytime employment base
- Zoned commercial – supports a wide range of retail, service, and commercial uses
- Excellent location within minutes of the I-90 and US-20 interchange

DEMOGRAPHICS

	1 Mile	3 Miles	5 Miles
Total Population	7,149	63,787	145,766
Average HH Income	\$85,639	\$95,012	\$86,539
Daytime Population	8,548	61,104	163,658

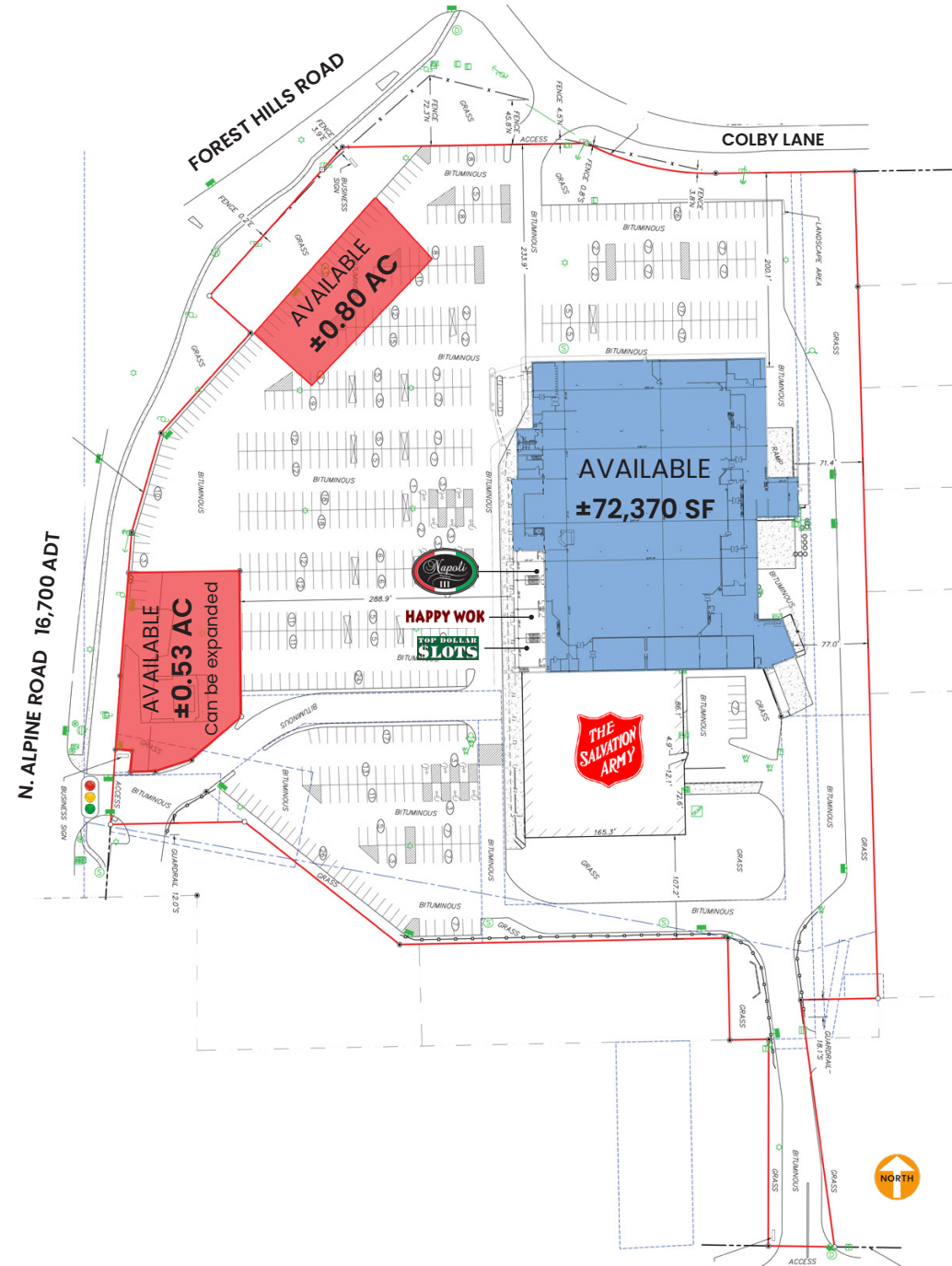

RETAIL AND OUTLOTS AVAILABLE FOR LEASE OR GROUND LEASE

6550 N. ALPINE ROAD

SEC Alpine Road and Forest Hills Road | Loves Park, Illinois 61111



6550 N. Alpine Road
Retail Space Available
±72,370 SF

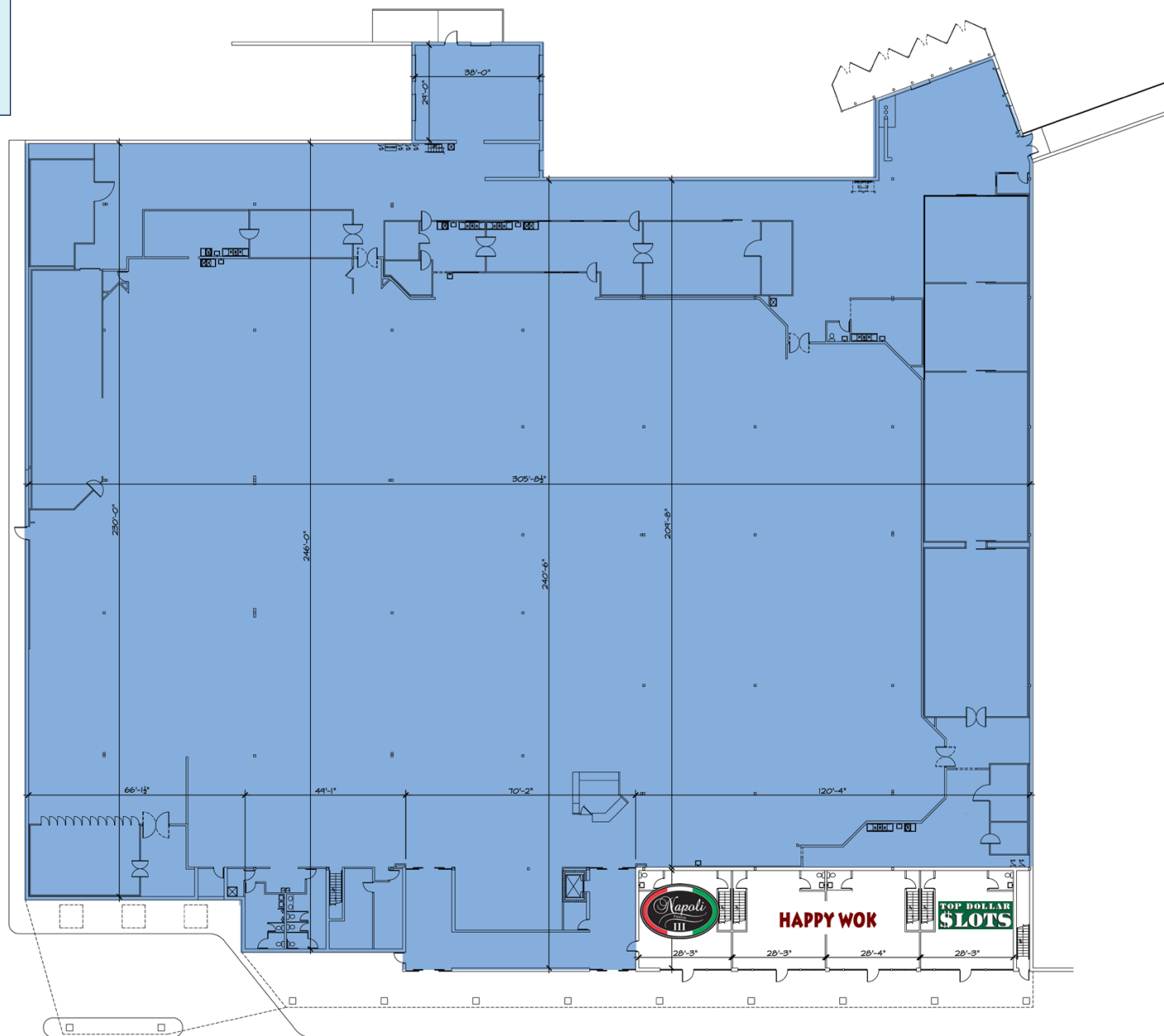

Alpine Road 16,700 ADT

RETAIL AND OUTLOTS AVAILABLE FOR LEASE OR GROUND LEASE

6550 N. ALPINE ROAD

SEC Alpine Road and Forest Hills Road | Loves Park, Illinois 61111

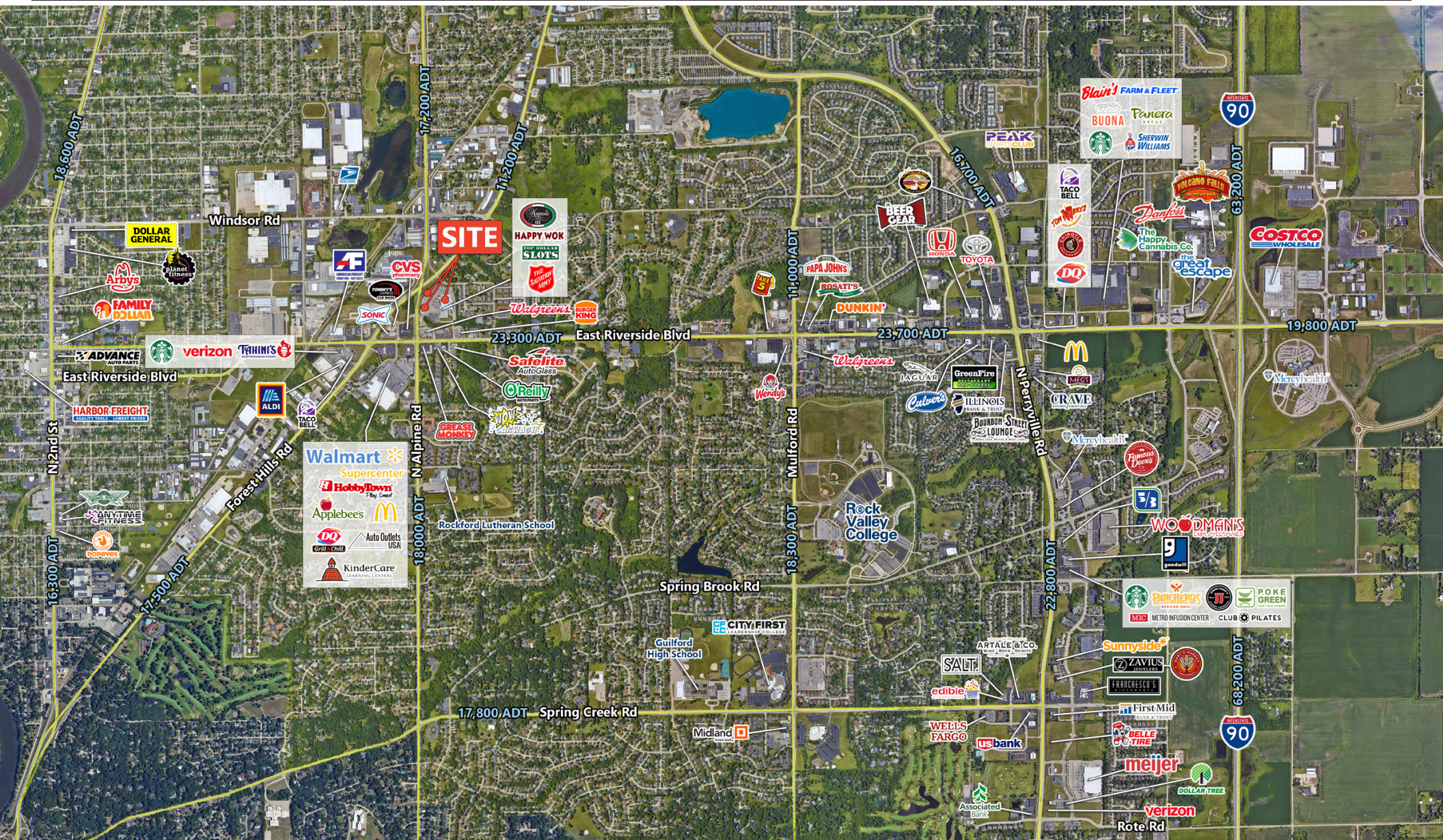

FOR MORE
INFORMATION
CONTACT

LAUREN SZYMELL
lszymell@arcgrp.com
630.908.5703

DANIELLE KLING
danielle@arcgrp.com
630.908.5693

**REALTY
RESOURCES**
MEMBER

The information above has been obtained from sources believed reliable. While we do not doubt its accuracy, we have not verified it and make no guarantee, warranty or representation about it.